

Inquiry

Commission:

or

Order

Note:

TWINLINE 2

length	width	tub capacity
--------	-------	--------------

- | | | | |
|--------------------------|--------|-------|--------------------|
| <input type="checkbox"/> | 160 cm | 75 cm | approx. 180 liters |
| <input type="checkbox"/> | 170 cm | 75 cm | approx. 200 liters |
| <input type="checkbox"/> | 170 cm | 80 cm | approx. 220 liters |
| <input type="checkbox"/> | 180 cm | 80 cm | approx. 240 liters |

Shower door:



Total height: 211 cm

Door height: 197 cm

Door height from top edge of the bathtub: 150 cm

Bathtub colour: white

Glass: 8 mm ESG

Shower door with side screen:

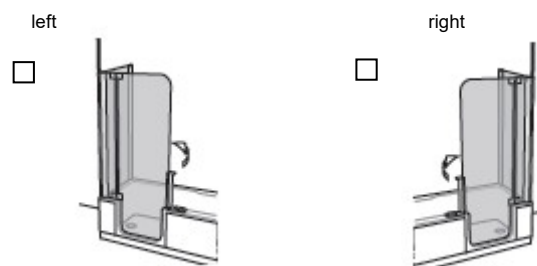

Options bathtub: inlet/drain/overflow Art-Grip

Sealing Tape

Options shower door: ARTCLEAR

Profile colours: high-gloss metal white silver

Installation variants: in alcove In corner on straight wall (shower door with side screen required)

Panels: (choose one option)

plastic	white <input type="checkbox"/>	glass:	clear <input type="checkbox"/>	Artwall:	WM matt white <input type="checkbox"/>
			anthracite <input type="checkbox"/>		WG glossy white <input type="checkbox"/>
			bordeaux <input type="checkbox"/>		DU glossy dark grey <input type="checkbox"/>
					GG glossy silver grey <input type="checkbox"/>
					BO glossy bordeaux <input type="checkbox"/>
					SN matt sand <input type="checkbox"/>
					CY canyon <input type="checkbox"/>
					BT concrete <input type="checkbox"/>
					RS rust <input type="checkbox"/>
					SC slate <input type="checkbox"/>
					SD black decor <input type="checkbox"/>
					WD white decor <input type="checkbox"/>
					AH maple <input type="checkbox"/>
					EI light oak <input type="checkbox"/>
					KR light cherry <input type="checkbox"/>

or

Tile substrate:

Bathtub wit AIR system:

(air jets, LED coloured light)

Compound bracket:

yes

no

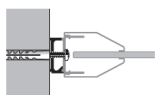

(Required when bathtub is installed on ready tiled wall)

Back rest:

yes

no



(Fixation on the bathtub with suction cups)

Folding seat:

yes

no



(For installation on tiled wall)

Corner seat:

yes

no



(Can also be retrofitted to existing TWINLINE 2 bathtub. Can be removed at any time!)

Pivoting splashguard:

yes

no

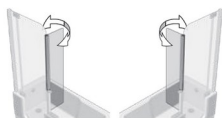

(Can be retrofitted later)