

Inquiry

Commission:

or

Order

Note:

TWINLINE 2 with bathtub door / shower screen

length	width	cub capacity
--------	-------	--------------

- 160 cm 75 cm approx. 180 liters
- 170 cm 75 cm approx. 200 liters
- 170 cm 80 cm approx. 220 liters
- 180 cm 80 cm Approx. 240 liters

Bathtub with bathtub door:



left

right

Shower screen:

left

right

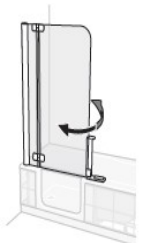

Shower screen with side screen:



Options bathtub:

inlet/drain/overflow Art-Grip

sealing tape

Options bathtub door:

ARTCLEAR

Installation variants:

in alcove

in corner

on straight wall

(Side screen required for option with shower screen)

Panels:

(choose one option)

plastic:

white

Glass:

clear

anthrazite

bordeaux

Artwall:

WM matt white

WG glossy white

WG glossy white

GG glossy silver grey

BO glossy bordeaux

SN matt sand

BT concrete

RS rust

SC slate

SD black decor

WD white decor

AH maple

EI light oak

KR light cherry

CY canyon

or

Tile substrate:

bathtub with AIR system:

(air jets, LED coloured light)

Compound bracket:

yes

no

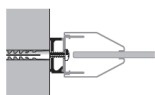

(Required when bathtub is installed on ready tiled wall. Only if installed with shower screen.)

Back rest:

yes

no



(Fixation on the bathtub with suction cups.)

Folding seat:

yes

no



(Für Wandmontage.)

Corner seat:

yes

no



(Can also be retrofitted to existing TWINLINE 2 bathtub. Can be removed at any time!)

A pivoting splashguard can't be installed on a variant with split door!